

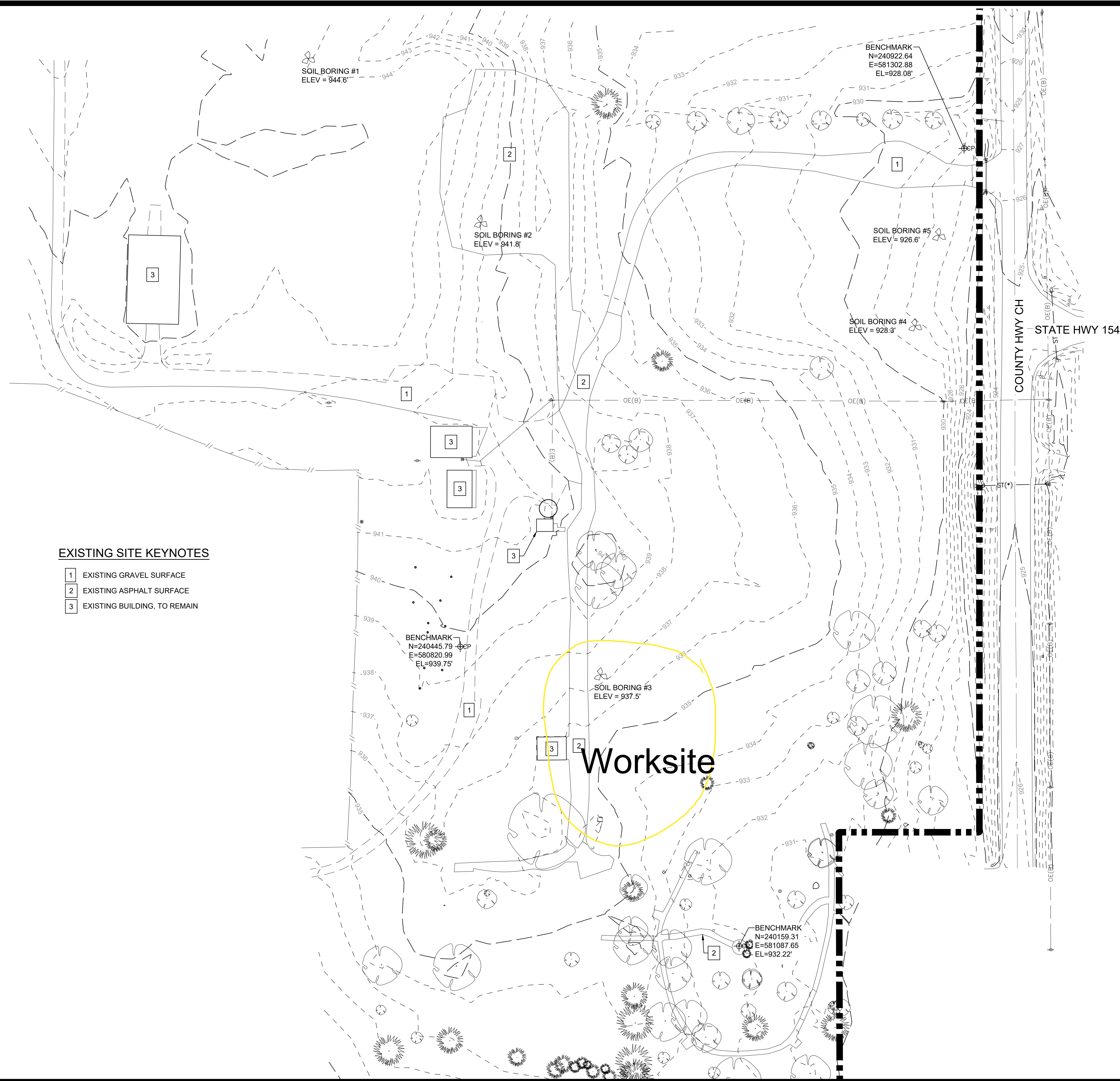

W:\Projects\2023\123\0424\304\DDI\123456\_Plan\_Snry\_NDY\_MEESMANN\_EXISTING\_SITE\_20231229\_1226.PLT, ANSI FULL BLEED D (34.00 X 22.00 INCHES)



**EXISTING SITE KEYNOTES**

- 1 EXISTING GRAVEL SURFACE
- 2 EXISTING ASPHALT SURFACE
- 3 EXISTING BUILDING, TO REMAIN

**LEGEND**

**FOUND**

- Section Corner
- 1/2" Rebar, Cap # 11579 (Unless Otherwise Noted)
- ROW Marker
- ROW Rail
- Control Point
- Bench Mark
- Platted Distance
- Measured Bearing & Distance
- Recorded As
- Deed Distance
- Calculated Distance
- Minimum Protection Elevation
- Centerline
- Section Line
- 1/4 Section Line
- 1/4 1/4 Section Line
- Easement Line

**FEATURES**

- Spot Elevation
- Contour Elevation
- Fence (Barbed, Field, Hog)
- Fence (Chain Link)
- Fence (Wood)
- Fence (Silt)
- Tree Line
- Tree Stump
- Deciduous Tree \ Shrub
- Coniferous Tree \ Shrub
- Communication
- Overhead Communication
- Fiber Optic
- Underground Electric
- Overhead Electric
- Gas Main with Size
- High Pressure Gas Main with Size
- Water Main with Size
- Sanitary Sewer with Size
- Duct Bank
- Test Hole Location for SUE w/ID

(\*) Denotes the survey quality service level for utilities

- Sanitary Manhole
- Storm Sewer with Size
- Storm Manhole
- Single Storm Sewer Intake
- Double Storm Sewer Intake
- Fire Hydrant
- Fire Hydrant on Building
- Water Main Valve
- Water Service Valve
- Well
- Utility Pole
- Guy Anchor
- Utility Pole with Light
- Utility Pole with Transformer
- Street Light
- Yard Light
- Electric Box
- Electric Transformer
- Traffic Sign
- Communication Pedestal
- Communication Manhole
- Communication Handhole
- Fiber Optic Manhole
- Fiber Optic Handhole
- Gas Valve
- Gas Manhole
- Gas Apparatus
- Fence Post or Guard Post
- Underground Storage Tank
- Above Ground Storage Tank
- Sign
- Satellite Dish
- Mailbox
- Sprinkler Head
- Irrigation Control Valve
- Soil Boring

**Elevation**

- Section Number
- Drawing Number

**Removal Items**

**FOUND**

- Section Corner
- 1/2" Rebar, Cap # 11579 (Unless Otherwise Noted)
- ROW Marker
- ROW Rail
- Control Point
- Bench Mark
- Platted Distance
- Measured Bearing & Distance
- Recorded As
- Deed Distance
- Calculated Distance
- Minimum Protection Elevation
- Centerline
- Section Line
- 1/4 Section Line
- 1/4 1/4 Section Line
- Easement Line

**EXISTING**

- Spot Elevation
- Contour Elevation
- Fence (Barbed, Field, Hog)
- Fence (Chain Link)
- Fence (Wood)
- Fence (Silt)
- Tree Line
- Tree Stump
- Deciduous Tree \ Shrub
- Coniferous Tree \ Shrub
- Communication
- Overhead Communication
- Fiber Optic
- Underground Electric
- Overhead Electric
- Gas Main with Size
- High Pressure Gas Main with Size
- Water Main with Size
- Sanitary Sewer with Size
- Duct Bank
- Test Hole Location for SUE w/ID

**SET**

- Section Corner
- 1/2" Rebar, Cap # 11579 (Unless Otherwise Noted)
- ROW Marker
- ROW Rail
- Control Point
- Bench Mark
- Platted Distance
- Measured Bearing & Distance
- Recorded As
- Deed Distance
- Calculated Distance
- Minimum Protection Elevation
- Centerline
- Section Line
- 1/4 Section Line
- 1/4 1/4 Section Line
- Easement Line

**PROPOSED**

- Spot Elevation
- Contour Elevation
- Fence (Barbed, Field, Hog)
- Fence (Chain Link)
- Fence (Wood)
- Fence (Silt)
- Tree Line
- Tree Stump
- Deciduous Tree \ Shrub
- Coniferous Tree \ Shrub
- Communication
- Overhead Communication
- Fiber Optic
- Underground Electric
- Overhead Electric
- Gas Main with Size
- High Pressure Gas Main with Size
- Water Main with Size
- Sanitary Sewer with Size
- Duct Bank
- Test Hole Location for SUE w/ID

**NOT FOR CONSTRUCTION**

 TO OBTAIN LOCATION OF PARTICIPANTS' UNDERGROUND FACILITIES BEFORE YOU DIG IN WISCONSIN  
**CALL DIGGERS HOTLINE**  
**1-800-242-8511**  
**TOLL FREE**  
 WIS. STATUTE 182.0175 (1974)  
 REQUIRES MIN. OF 3 WORK DAYS  
 NOTICE BEFORE YOU EXCAVATE

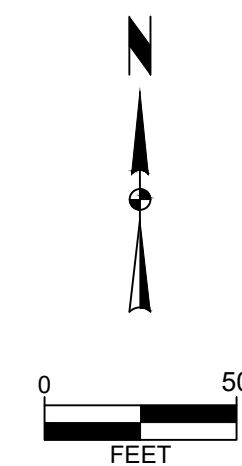

**SAUK COUNTY FARM EDUCATION HUB - PHASE 1**

**EXISTING SITE**

**SNYDER & ASSOCIATES, INC.**



Project No: 123.0424.30  
Sheet C 100

MARK	REVISION	DATE	BY

Engineer: SJA	Checked By: ATM	Scale: 1" = 50'
Technician: ADB	Date: 12-29-2023	T-R-S: T12N-R04E-S34

Project No: 123.0424.30  
Sheet C 100

5010 VOGES ROAD  
MADISON, WISCONSIN 53718  
608-838-0444 | www.snyder-associates.com















**GENERAL LANDSCAPE NOTES**

- UTILITY WARNING: THE UTILITIES SHOWN HAVE BEEN LOCATED FROM FIELD SURVEY INFORMATION AND/OR RECORDS OBTAINED. THE SURVEYOR MAKES NO GUARANTEE THAT THE UTILITIES SHOWN COMPRISE ALL SUCH UTILITIES IN THE AREA, EITHER IN SERVICE OR ABANDONED. THE SURVEY FURTHER DOES NOT WARRANT THAT THE UTILITIES SHOWN ARE IN THE EXACT LOCATION INDICATED.
- NOTIFY UTILITY OWNERS PRIOR TO BEGINNING ANY CONSTRUCTION. CONTRACTOR IS RESPONSIBLE FOR DETERMINING EXISTENCE, EXACT LOCATION AND DEPTH OF ALL UTILITIES. AVOID DAMAGE TO UTILITIES AND SERVICES DURING CONSTRUCTION. ANY DAMAGE DUE TO THE CONTRACTOR'S CARELESSNESS SHALL BE CORRECTED AT THE CONTRACTOR'S EXPENSE. COORDINATE AND COOPERATE WITH UTILITY COMPANIES DURING CONSTRUCTION.
- THE CONTRACTOR SHALL FOLLOW THE LANDSCAPE PLANS AS CLOSELY AS POSSIBLE. ANY SUBSTITUTION OR ALTERATION SHALL NOT BE ALLOWED WITHOUT APPROVAL OF THE OWNER'S REPRESENTATIVE. OVERALL PLANT QUANTITY AND QUALITY SHALL BE CONSISTENT WITH THE PLANS.
- ALL PLANT MATERIAL SHALL AT LEAST MEET MINIMUM REQUIREMENTS SHOWN IN THE "AMERICAN STANDARDS FOR NURSERY STOCK" (ANSI Z60.1-LATEST EDITION).
- MULCH SHALL NOT BE PLACED AROUND THE COLLAR OF SHRUB OR TREE. PROVIDE A MINIMUM OF 2" BETWEEN MULCH AND COLLAR OF SHRUB OR TREE.
- ALL PLANT MATERIAL SHALL BE GROWN IN ZONE CAPABLE OF WITHSTANDING LOCAL CLIMATE AND GROWING CONDITIONS.
- TREE OR SHRUB SHALL STAND PLUMB. DO NOT ALLOW AIR POCKETS TO FORM WHEN BACK FILLING.
- LIVE PLANTS CAN BE PLANTED IN THE FIELD DURING THE GROWING SEASON FROM MAY 1 THROUGH OCTOBER 1. ANY SUGGESTED PLANTING TIMES NOT IN THIS WINDOW SHALL BE APPROVED BY LANDSCAPE ARCHITECT. IF PLANTING OCCURS OUTSIDE OF THIS WINDOW, ADDITIONAL MEASURES MAY NEED TO BE TAKEN (I.E. MULCH) TO ENSURE PLANT SURVIVAL. IN THESE INSTANCES, THE CONTRACT PRICE MAY NEED TO BE ADJUSTED ACCORDINGLY.
- BARE ROOT TREES SHALL BE PLANTED IN THE FIELD DURING TREE DORMANCY - IN THE FALL AFTER THE LEAVES HAVE DROPPED OR EARLY SPRING BEFORE LEAVES, FRUIT OR NEW GROWTH APPEARS. EVERGREEN BARE ROOT TREES SHALL BE PLANTED WHEN LIGHT BROWN CLUSTERS FORM AT THE TOP OF THE TREE. ALL BARE ROOT TREES AND PLANTS SHALL BE SOAKED IN WATER 3 TO 6 HOURS PRIOR TO PLANTING. DO NOT ALLOW ROOTS TO DRY.
- PLANTS SHOULD BE WATERED IN AFTER INSTALLATION TO ENSURE THEIR SURVIVAL. THIS TYPICALLY INVOLVES WATERING AT TIME OF INSTALLATION AND 2 TIMES WEEKLY FOR A ONE MONTH PERIOD OR UNTIL GROUND FREEZE UP IF NATURAL RAINFALLS ARE INSUFFICIENT. A SINGLE WATERING EVENT INVOLVES WATERING THE SOIL IN THE PLANTED AREAS TO THE POINT OF SATURATION BUT STOPPING SHORT OF SOIL DISPLACEMENT. SHOULD VERY DRY CONDITIONS DEVELOP WITHIN ONE YEAR OF PLANTING, ADDITIONAL WATERINGS MAY BE NECESSARY. CONSULTANT OR LANDSCAPE ARCHITECT WILL DETERMINE THIS AND CONTRACT PRICES MAY BE ADJUSTED TO ACCOMMODATE THIS ACTION.
- ALL PLANT MATERIAL SHALL BE SPECIMEN QUALITY, HEALTHY, FREE OF DISEASE AND INSECTS AND SHALL HAVE HEALTHY, WELL-DEVELOPED ROOT SYSTEMS. PLANTS SHALL ALSO BE FREE FROM PHYSICAL DAMAGE OR OTHER CONDITIONS THAT WOULD PREVENT VIGOROUS GROWTH.
- ALL PROPOSED PLANTS SHALL BE LOCATED AS SHOWN ON PLANS. ALL TREES TO BE PLANTED A MINIMUM DISTANCE OF 5 FEET FROM PAVEMENTS AND 6 FEET FROM ALL HYDRANTS.
- CONTRACTOR IS RESPONSIBLE FOR PLANTS AWAITING INSTALLATION AND SHALL PROTECT THEM FROM INJURY AND THEFT.
- THE CONTRACTOR IS RESPONSIBLE FOR VERIFYING ALL PLANT QUANTITIES. GRAPHIC QUANTITIES TAKES PRECEDENCE OVER WRITTEN QUANTITIES.
- THE OWNER'S REPRESENTATIVE RESERVES THE RIGHT TO INSPECT AND TAG ALL PLANT MATERIAL PRIOR TO SHIPPING TO THE SITE. IN ALL CASES, THE OWNER'S REPRESENTATIVE MAY REJECT PLANT MATERIAL AT THE SITE IF MATERIAL IS DAMAGED, DISEASED, OR DECLINING IN HEALTH AT THE TIME OF ONSITE INSPECTIONS OR IF THE PLANT MATERIAL DOES NOT MEET THE MINIMUM SPECIFIED STANDARD IDENTIFIED ON THE PLANS. THE CONTRACTOR SHALL COORDINATE WITH THE OWNER'S REPRESENTATIVE FOR INSPECTION AND APPROVAL OF ALL MATERIALS AND PRODUCTS PRIOR TO INSTALLATION.
- THE OWNER'S REPRESENTATIVE MAY ELECT TO UPSIZE PLANT MATERIAL AT THEIR DISCRETION BASED ON SELECTION, AVAILABILITY, OR TO ENHANCE SPECIFIC AREAS OF THE PROJECT. THE CONTRACTOR SHALL VERIFY PLANT MATERIAL SIZES WITH OWNER'S REPRESENTATIVE PRIOR TO PURCHASING, SHIPPING OR STOCKING OF PLANT MATERIALS. SUBMIT CHANGE ORDER REQUEST TO OWNER'S REPRESENTATIVE FOR APPROVAL IF ADDITIONAL COST IS REQUESTED BY THE CONTRACTOR PRIOR TO INSTALLATION. RE-STOCKING CHARGES WILL NOT BE APPROVED IF THE CONTRACTOR FAILS TO SUBMIT A REQUEST FOR MATERIAL CHANGES.
- THE CONTRACTOR SHALL WARRANTY ALL CONTRACTED WORK AND MATERIALS FOR A PERIOD OF ONE YEAR AFTER SUBSTANTIAL COMPLETION HAS BEEN ISSUED BY THE OWNER'S REPRESENTATIVE FOR THE ENTIRE PROJECT UNLESS OTHERWISE SPECIFIED IN THE CONTRACT DOCUMENTS.
- LANDSCAPE MATERIAL LOCATIONS SHALL HAVE PRECEDENCE OVER IRRIGATION MAINLINE AND LATERAL LOCATIONS. IF IRRIGATION IS INCLUDED, COORDINATE INSTALLATION OF IRRIGATION EQUIPMENT SO THAT IT DOES NOT INTERFERE WITH THE PLANTING OF TREES OR OTHER LANDSCAPE MATERIAL.
- THE LANDSCAPE CONTRACTOR SHALL BE RESPONSIBLE FOR ENSURING POSITIVE DRAINAGE EXISTS IN ALL LANDSCAPE AREAS. SURFACE DRAINAGE ON LANDSCAPE AREAS SHALL NOT FLOW TOWARD STRUCTURES AND FOUNDATIONS. MAINTAIN SLOPE AWAY FROM FOUNDATIONS PER THE GEOTECHNICAL REPORT RECOMMENDATIONS. ALL LANDSCAPE AREAS BETWEEN WALKS AND CURBS SHALL DRAIN FREELY TO THE CURB UNLESS OTHERWISE IDENTIFIED ON THE GRADING PLAN. IN NO CASE SHALL THE GRADE, TURF THATCH, OR OTHER LANDSCAPE MATERIALS DAM WATER AGAINST WALKS. MINIMUM SLOPES ON LANDSCAPE AREAS SHALL BE 2%. MAXIMUM SLOPE SHALL BE 25% UNLESS SPECIFICALLY IDENTIFIED ON THE PLANS OR APPROVED BY THE OWNER'S REPRESENTATIVE.
- PRIOR TO INSTALLATION OF PLANT MATERIALS, AREAS THAT HAVE BEEN COMPACTED OR DISTURBED BY CONSTRUCTION ACTIVITY SHALL BE THOROUGHLY LOOSENED TO A DEPTH OF 8" - 12".
- ALL LANDSCAPED AREAS ARE TO RECEIVE ORGANIC SOIL PREPARATION PER RATE IDENTIFIED BY A SOIL TEST.

**BIORETENTION PLANTING NOTES**

- BIORETENTION SHALL CONFORM TO WIS. DNR TECH STANDARD 1004.
- ENGINEERED SOIL SHALL CONSIST OF 70%-85% SILICA SAND AND 15%-30% COMPOST WITH A PH OF 5.5-6.5
- BIORETENTION BASINS SHALL BE EXCAVATED AND USED AS SEDIMENT TRAPS DURING CONSTRUCTION. UPON COMPLETION OF CONSTRUCTION AND SITE STABILIZATION, THE BASINS SHALL BE OVER-EXCAVATED 3 FEET MINIMUM AND THEN THE SAND LAYER AND ENGINEERED SOIL SHALL BE PLACED TO WITHIN THREE INCHES OF FINAL GRADE. ONCE THE ENGINEERED SOIL IS PLACED, A COCONUT FIBER MAT SHALL BE ADDED ON TOP OF THE ENGINEERED SOIL.
- FIELD INFILTRATION TESTING: IMMEDIATELY AFTER ROUGH GRADING OF STORMWATER BIOINFILTRATION AND INFILTRATION DEVICES, PROVIDE FIELD INFILTRATION TESTING CONDUCTED BY A THIRD-PARTY TESTING AGENCY TO VERIFY INFILTRATION RATES FOR ALL STORMWATER BIOINFILTRATION AND INFILTRATION DEVICES. DETERMINE INFILTRATION RATES IN ACCORDANCE WITH WISCONSIN DEPARTMENT OF NATURAL RESOURCES (WDNR) SITE EVALUATION FOR STORMWATER INFILTRATION, STANDARD 1002. FREQUENCY OF TESTING SHALL BE 1 TEST PER 5000 SQUARE FEET OF SURFACE AREA OF THE STORMWATER INFILTRATION DEVICE MEASURED AT THE DESIGN HIGH WATER LEVEL AND AT LEAST ONE TEST PER DEVICE. FURNISH A REPORT OF THE TEST RESULTS TO ARCHITECT/ENGINEER. TESTING SHALL BE COMPLETED AT THE EXPENSE OF THE CONTRACTOR.
- SPECIFIC SPECIES OR CONTAINER SIZE SUGGESTED SUBSTITUTIONS SHALL BE PRESENTED TO CONSULTANT ALONG WITH THE REASONS FOR THE SUGGESTIONS. WITH CONSULTANT OR PROJECT ENGINEER'S APPROVAL, SUBSTITUTIONS MAY BE MADE.
- LIVE PLANTS CAN BE PLANTED IN THE FIELD DURING THE GROWING SEASON FROM MAY 1 THROUGH OCTOBER 1. ANY SUGGESTED PLANTING TIMES NOT IN THIS WINDOW SHALL BE APPROVED BY CONSULTANT OR ENGINEER. IF PLANTING OCCURS OUTSIDE OF THIS WINDOW ADDITIONAL MEASURES MAY NEED TO BE TAKEN (I.E. MULCH) TO ENSURE PLANT SURVIVAL. IN THESE INSTANCES, THE CONTRACT PRICE MAY NEED TO BE ADJUSTED ACCORDINGLY.
- ALL PLANTED MATERIALS WILL BE WARRANTED BY INSTALLATION CONTRACTOR TO BE IN HEALTHY CONDITION WITH A REPLACEMENT GUARANTEE FOR A PERIOD OF ONE YEAR FROM THE DATE OF PLANTING.
- NATIVE PLANTS SHOULD BE WATERED IN AFTER INSTALLATION TO ENSURE THEIR SURVIVAL. THIS TYPICALLY INVOLVES WATERING AT TIME OF INSTALLATION AND 2 TIMES WEEKLY FOR A ONE MONTH PERIOD OR UNTIL GROUND FREEZE UP IF NATURAL RAINFALLS ARE INSUFFICIENT. A SINGLE WATERING EVENT INVOLVES WATERING THE SOIL IN THE PLANTED AREAS TO THE POINT OF SATURATION BUT STOPPING SHORT OF SOIL DISPLACEMENT. SHOULD VERY DRY CONDITIONS DEVELOP WITHIN ONE YEAR OF PLANTING, ADDITIONAL WATERINGS MAY BE NECESSARY. CONSULTANT OR PROJECT ENGINEER WILL DETERMINE THIS AND CONTRACT PRICES MAY BE ADJUSTED TO ACCOMMODATE THIS ACTION.
- PLANTS SHALL BE PLANTED IN THE BIORETENTION AREA AT A MINIMUM OF ONE PLANT PER EVERY 12" ON CENTER.
- UPON COMPLETION OF EXCAVATING & GRADING OPERATIONS, A LOOSE, FRIABLE PLANT BED SHALL BE PREPARED FOR INSTALLATION OF NATIVE PLANT PLUGS.
- CARE SHALL BE TAKEN TO MINIMIZE SOIL COMPACTION DURING CONSTRUCTION ACTIVITY. BY EXAMPLE OF A STANDARD SOIL PENETROMETER (COMPACTION TESTER), THE TOPSOIL COMPACTION READINGS SHALL BE LESS THAN 200 PSI AT THE 0-6 INCH DEPTH AND LESS THAN 250 PSI AT THE 6-18 INCH DEPTHS IN ALL AREAS TO BE PLANTED.
- UNDULATIONS OR IRREGULARITIES IN THE PLANT BED WHICH WOULD INTERFERE WITH A CONSISTENT SEEDING OPERATION SHALL BE LEVELED PRIOR TO FINAL SEEDING.
- FINAL PLANTING AREA SHOULD BE GRADED SUCH THAT THE AREAS TO BE PLANTED SHALL CONSIST OF A SMOOTH, FREE DRAINING, EVEN SURFACE WITH A LOOSE POROUS TEXTURE.

Common Name	Scientific Name	Growth Form
Swamp milkweed	Asclepia incarnata	Forb
Boneset	Eupatorium perfoliatum	Forb
Spotted Joe-Pye Weed	Eutrochium maculatum	Forb
Tall sunflower	Helianthus giganteus	Forb
Cardinal flower	Lobelia cardinalis	Forb
Blue lobelia	Lobelia siphilitica	Forb
Virginia mountain mint	Pycnanthemum virginianum	Forb
New England Aster	Symphotrichum novae-angliae	Forb
Blue vervain	Verbena hastata	Forb
Canada blue joint	Calamagrostis Canadensis	Grass
Virginia wild rye	Elymus virginicus	Grass
Prairie cordgrass	Spartina pectinata	Grass
Bebb's sedge	Carex bebbiana	Sedge
Tussock sedge	Carex stricta	Sedge
Fox sedge	Carex vulpinoidea	Sedge
Dark green bulrush	Scirpus atrovirens	Sedge
Woolgrass	Scirpus cyperinus	Sedge

Install an equal mix of all listed plants



NOT FOR CONSTRUCTION

Table 1. Sauk County Farm Education Hub: Prairie Seed Mix<sup>1</sup>

Nomenclature	Seed Metrics					
	Scientific Name	Common Name	Oz/Acre	Seeds/Oz	Seeds/ft <sup>2</sup>	% Mix by No. Seeds
<b>Grasses, Sedges, Rushes</b>						
<i>Andropogon gerardii</i>	Big Bluestem	4.00	10,000	0.90	1.66	
<i>Bouteloua curtipendula</i>	Side oats Grama	36.00	6,000	5.00	8.95	
<i>Carex bicknellii</i>	Bicknell's Oval Sedge	0.50	17,000	0.20	0.35	
<i>Carex brevior</i>	Fescue Sedge	0.75	29,000	0.50	0.90	
<i>Carex molesta</i>	Field Oval Sedge	0.50	25,000	0.30	0.52	
<i>Elymus canadensis</i>	Canada Wild Rye	28.00	5,200	3.30	6.03	
<i>Panicum virgatum</i>	Switch Grass	2.00	14,000	0.60	1.16	
<i>Schizachyrium scoparium</i>	Little Bluestem	28.00	15,000	9.60	17.41	
<i>Sorghastrum nutans</i>	Indian Grass	6.00	12,000	1.70	2.98	
<b>Forbs</b>						
<i>Agastache foeniculum</i>	Blue Giant Hyssop	0.50	90,000	1.00	1.86	
<i>Allium cernuum</i>	Nodding Onion	1.00	7,600	0.20	0.31	
<i>Amorpha canescens</i>	Lead Plant	1.50	16,000	0.60	0.99	
<i>Arnoglossum atriplicifolium</i>	Prairie Plantain	1.00	6,000	0.10	0.25	
<i>Artemisia ludoviciana</i>	Louisiana Sage Wort	0.20	290,000	1.10	2.07	
<i>Asclepias tuberosa</i>	Butterfly Weed	1.50	4,300	0.10	0.27	
<i>Astragalus canadensis</i>	Canadian Milk Vetch	1.50	17,000	0.60	1.06	
<i>Baptisia alba</i>	White Wild Indigo	1.50	1,700	0.00	0.07	
<i>Chamaecrista fasciculata</i>	Partridge Pea	6.00	2,700	0.40	0.67	
<i>Dalea candida</i>	White Prairie Clover	1.00	19,000	0.40	0.79	
<i>Dalea purpurea</i>	Purple Prairie Clover	4.00	15,000	1.40	2.49	
<i>Drymocalis arguta</i>	Prairie Cinquefoil	0.60	230,000	3.20	5.72	
<i>Echinacea pallida</i>	Pale Purple Coneflower	2.00	5,200	0.20	0.43	
<i>Eryngium yuccifolium</i>	Rattlesnake Master	1.50	7,500	0.30	0.47	
<i>Helopsis helianthoides</i>	False Sunflower	1.50	6,300	0.20	0.39	
<i>Lespedeza capitata</i>	Round-headed Bush Clover	1.00	8,000	0.20	0.33	
<i>Liatris aspera</i>	Rough Blazing Star	0.50	16,000	0.20	0.33	
<i>Lupinus perennis</i>	Wild Lupine	1.00	1,100	0.00	0.05	
<i>Monarda fistulosa</i>	Wild Bergamot	1.00	70,000	1.60	2.90	
<i>Oligoneuron rigidum</i>	Stiff Goldenrod	1.50	41,000	1.40	2.55	
<i>Pycnanthemum virginianum</i>	Mountain Mint	0.20	220,000	1.00	1.82	
<i>Ratibida pinnata</i>	Yellow Coneflower	1.50	30,000	1.00	1.86	
<i>Rudbeckia hirta</i>	Black-eyed Susan	4.00	92,000	8.40	15.25	
<i>Silphium laciniatum</i>	Compass Plant	2.00	660	0.00	0.05	
<i>Solidago speciosa</i>	Showy Goldenrod	0.50	95,000	1.10	1.97	
<i>Symphotrichum laeve</i>	Smooth Blue Aster	1.00	55,000	1.30	2.28	
<i>Symphotrichum novae-angliae</i>	New England Aster	0.20	66,000	0.30	0.55	
<i>Tradescantia ohioensis</i>	Ohio Spiderwort	1.50	8,000	0.30	0.50	
<i>Verbena stricta</i>	Hoary Vervain	2.00	28,000	1.30	2.32	
<i>Veronicastrum virginicum</i>	Culver's Root	0.25	800,000	4.60	8.29	
<i>Zizia aurea</i>	Golden Alexanders	2.50	11,000	0.60	1.14	

Plant Type	Species Richness	Total Oz/Acre	Total Seeds/ft <sup>2</sup>	% Mix by No. Seeds
Grasses and Sedges	9	105.8	22.1	40.0
Forbs	31	45.5	33.3	60.0
<b>Totals</b>	<b>40</b>	<b>151.2</b>	<b>55.4</b>	<b>100</b>

<sup>1</sup>Seed mix is designed for 1.0 acre. This seed mix should be installed with an appropriate temporary cover crop based on timing of installation.

Table 2. Sauk County Farm Education Hub: Oak Savanna Seed Mix<sup>1</sup>

Nomenclature	Seed Metrics					
	Scientific Name	Common Name	Oz/Acre	Seeds/Oz	Seeds/ft <sup>2</sup>	% Mix by No. Seeds
<b>Grasses, Sedges, Rushes</b>						
<i>Andropogon gerardii</i>	Big Bluestem	8.00	10,000	1.80	2.61	
<i>Bouteloua curtipendula</i>	Side oats Grama	6.00	6,000	0.80	1.18	
<i>Bromus kalmii</i>	Prairie Brome	6.00	8,000	1.10	1.57	
<i>Carex blanda</i>	Common Wood Sedge	2.00	12,500	0.60	0.82	
<i>Carex brevior</i>	Fescue Sedge	1.00	29,000	0.70	0.95	
<i>Carex molesta</i>	Field Oval Sedge	1.00	25,000	0.60	0.82	
<i>Elymus canadensis</i>	Canada Wild Rye	8.00	5,200	1.00	1.36	
<i>Elymus hystrix</i>	Bottlebrush Grass	10.00	7,600	1.70	2.48	
<i>Elymus villosus</i>	Hairy Wild Rye	8.00	5,500	1.00	1.44	
<i>Elymus virginicus</i>	Virginia Wild Rye	14.00	4,200	1.30	1.92	
<i>Festuca subverticillata</i>	Nodding Fescue	1.00	20,000	0.50	0.65	
<i>Panicum virgatum</i>	Switch Grass	2.00	14,000	0.60	0.91	
<i>Schizachyrium scoparium</i>	Little Bluestem	18.00	15,000	6.20	8.81	
<i>Sorghastrum nutans</i>	Indian Grass	6.00	12,000	1.70	2.35	
<b>Forbs</b>						
<i>Agastache foeniculum</i>	Blue Giant Hyssop	1.00	90,000	2.10	2.94	
<i>Agastache scrophulariaefolia</i>	Purple Giant Hyssop	1.00	93,000	2.10	3.04	
<i>Amorpha canescens</i>	Lead Plant	1.50	16,000	0.60	0.78	
<i>Aquilegia canadensis</i>	Columbine	2.00	38,000	1.70	2.48	
<i>Arnoglossum atriplicifolium</i>	Prairie Plantain	2.00	6,000	0.30	0.39	
<i>Asclepias tuberosa</i>	Butterfly Weed	1.50	4,300	0.10	0.21	
<i>Astragalus canadensis</i>	Canadian Milk Vetch	1.00	17,000	0.40	0.55	
<i>Blephilia hirsuta</i>	Hairy Wood Mint	0.50	240,000	2.80	3.92	
<i>Campanula americana</i>	Tall Bellflower	0.50	170,000	2.00	2.77	
<i>Chamaecrista fasciculata</i>	Partridge Pea	2.00	2,700	0.10	0.18	
<i>Dodecatheon meadia</i>	Eastern Shooting Star	0.50	60,000	0.70	0.98	
<i>Drymocalis arguta</i>	Prairie Cinquefoil	0.50	230,000	2.60	3.75	
<i>Echinacea pallida</i>	Pale Purple Coneflower	1.50	5,200	0.20	0.25	
<i>Eutrochium purpureum</i>	Purple Joe Pye Weed	0.50	42,000	0.50	0.69	
<i>Helopsis helianthoides</i>	False Sunflower	1.50	6,300	0.20	0.31	
<i>Lespedeza capitata</i>	Round-headed Bush Clover	1.00	8,000	0.20	0.25	
<i>Monarda fistulosa</i>	Wild Bergamot	1.50	70,000	2.40	3.43	
<i>Polemonium reptans</i>	Jacob's Ladder	1.00	18,000	0.40	0.59	
<i>Polygonatum biflorum</i>	Solomon's Seal	1.00	800	0.00	0.03	
<i>Ratibida pinnata</i>	Yellow Coneflower	1.00	30,000	0.70	0.98	
<i>Rudbeckia hirta</i>	Black-eyed Susan	4.00	92,000	8.40	12.01	
<i>Rudbeckia triloba</i>	Brown-eyed Susan	1.00	34,000	0.80	1.11	
<i>Scrophularia lanceolata</i>	Early Figwort	1.00	185,000	4.20	6.04	
<i>Solidago ulmifolia</i>	Elm-leaved Goldenrod	1.00	130,000	3.00	4.24	
<i>Symphotrichum laeve</i>	Smooth Blue Aster	0.50	55,000	0.60	0.9	
<i>Symphotrichum</i>	Calico Aster	0.50	250,000	2.90	4.08	
<i>lateniflorum</i>						
<i>Symphotrichum shortii</i>	Short's Aster	0.50	60,000	0.70	0.98	
<i>Tradescantia ohioensis</i>	Ohio Spiderwort	0.50	8,000	0.10	0.13	
<i>Veronicastrum virginicum</i>	Culver's Root	0.50	800,000	9.20	13.06	
<i>Zizia aurea</i>	Golden Alexanders	3.00	11,000	0.60	1.08	

Plant Type	Species Richness	Total Oz/Acre	Total Seeds/ft <sup>2</sup>	% Mix by No. Seeds
Grasses and Sedges	14	91.0	19.6	27.9
Forbs	30	35.5	50.7	72.2
<b>Totals</b>	<b>44</b>	<b>126.5</b>	<b>70.3</b>	<b>100</b>

<sup>1</sup>Seed mix is designed for 1.0 acre. This seed mix should be installed with an appropriate temporary cover crop based on timing of installation.

W:\Projects\2023\1224243\SaukCountyFarmEducationHub\LANDSCAPE NOTES\_20231229\_12:27 PM\_ANSI FULL BLEED.DWG ANDY NEESMANN LANDSCAPE NOTES\_20231229\_12:27 PM\_ANSI FULL BLEED.DWG (34.00 x 22.00 INCHES)

MARK	DATE	BY
REVISION	DATE	BY
Checked By: ATM	Scale: 1" = 40'	
Engineer: SJA	Date: 12-29-2023	
Technician: ADB	T-R-S: T12N-R04E-S34	

SAUK COUNTY FARM EDUCATION HUB - PHASE 1

LANDSCAPE NOTES

TOWN OF REEDSBURG, SAUK COUNTY, WISCONSIN

5010 VOGES ROAD  
MADISON, WISCONSIN 53718  
608-838-0444 | www.snyder-associates.com

SNYDER & ASSOCIATES, INC.

Sheet L 100



